

0bei11-L Land adjacent to Beili Home Farm, Gwynfe, Llangadog, Carmarthenshire, SA19 9PU

**Excellent level to very gently sloping pastureland**

**One Enclosure ( Field No: 3612) of c.11 ACRES available for sale,  
bound by stock fencing, suitable for Cattle, Sheep, Horse, or other livestock grazing –  
N.B. No Buildings of any type are to be erected on the land (Covenant in place).  
Formerly part of Beili Home Farm at Gwynfe in the Brecon Beacons National Park.  
Beautiful location about 4 miles from Llangadog village.**



**GUIDE PRICE £100,000**

Circa 11 Acres available for sale  
(enclosure No: 3612)

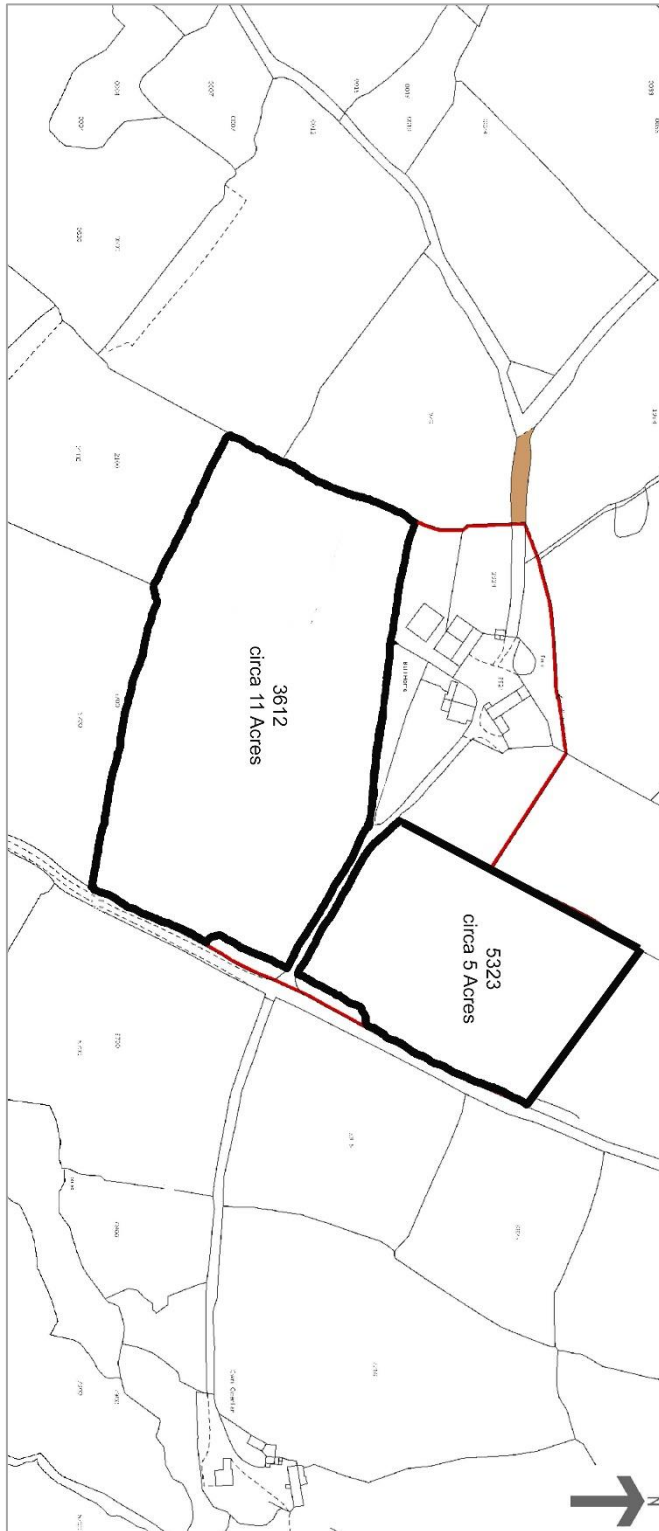

Figure 1

**SERVICES:** No services are connected to the site at present.

**COUNCIL TAX:** Carmarthenshire County Council

**WAYLEAVES, EASEMENTS & RIGHTS OF WAY:** The property is sold subject to and with the benefit of all wayleaves, easements and rights of way declared and undeclared.

N.B. A Covenant is in place stating that no buildings of any type are to be erected on the land.

**TENURE & POSSESSION:** We are informed that the property is freehold with vacant possession on completion, by arrangement.

**VIEWING:** **By appointment with PROFILE HOMES**



**Tel: 01550 777790**

**Email: [contact@profilehomes.com](mailto:contact@profilehomes.com)**

**Website: [www.profilehomes.com](http://www.profilehomes.com)**

---

**NOTES:** **PROFILE HOMES as agents for the vendors of this property give notice that these particulars have been produced in good faith and are intended only for guidance and assistance. These particulars do not constitute a contract or any part of a contract. The vendors have checked and approved these details.**

PROFILE HOMES have visited the property but have NOT surveyed or tested any of the appliances, services or systems in it including heating, plumbing, drainage, etc. Measurements and room dimensions are not guaranteed to be accurate and are given for guidance only. Purchasers must rely on their own and/or their Surveyor's inspections and their Solicitor's enquiries to determine the overall condition, size and acreage of the property, and also on Planning, Rights of Way, and all other matters relating to it.

**PROFILE HOMES**

Tel: 01550 777790, Email: [contact@profilehomes.com](mailto:contact@profilehomes.com), Web: [www.profilehomes.com](http://www.profilehomes.com)  
Penybanc Farm Office, Llangadog, Carmarthenshire, SA19 9DU

---

This document is Copyright © 2005-2016 PROFILE HOMES. All rights reserved. Any unauthorised reproduction or plagiarism will constitute an infringement of copyright.